



**City of Bath
Request for Proposals
Charter Boat Dock Project**

PROJECT DESCRIPTION

The City of Bath is partnering with the Bath Charter Boat Captains Association to construct a dock off Bridge Park in Bath, Maine. The dock will be used by local charter boat captains as a central location for charter boat tours in the City.

SCOPE OF WORK

Scope of work to include the construction/procurement, delivery and install of floating docks, gangway and hardware as outlined in the specs attached, as well as installation of helical anchors and chain detailed in the layout design and mooring scheme attached to this document. Contractor will be required to make necessary adjustments to moorings and chains to achieve desired stability of the system as specified by the City prior to final invoicing.

Attachments include project specifications and dock layout documents.

The project shall be complete no later than May 31, 2024.

SUBMISSION REQUIREMENTS

Please submit a proposal with the following information:

1. Company Name and Contact Information
2. Relevant Experience and Qualifications
3. Timeframe
4. Cost

Proposals must be delivered to the following address by 5:00PM on February 5, 2024:

City Manager's Office
c/o Charter Boat Dock Project Bid
55 Front Street
Bath, ME 04530

Questions may be emailed to Marc Meyers, City Manager, at mmeyers@cityofbath.com.

Each bidder must provide a bid guaranty for 5 percent of the bid amount. Failure to submit a bid guaranty causes the rejection of a bid.

RFP Timeline:

January 17, 2024	RFP Released
January 26, 2024	Last day to submit questions using RFI form
February 5, 2024 5:00PM	Bids Due
February 5, 2024 5:01PM	Public Bid Opening
February 14, 2024	Bid Selection and Notification

Bath Charter Boat Dock Design-Bid Specifications:

NOTE: The attached sketch is not an engineered drawing. The contractor is responsible for the design of this dock system.

The Bath Charter Boat Dock is located at Bridge Park in downtown Bath adjacent to the Sagadahoc Bridge.

Cement Bulkhead (existing) - A 10'X6' poured concrete bulkhead was installed spring 2022 as part of the River Walk Park project. Bulkhead was permitted by DEP through Wright Ryan.

Headworks - will be built from #2 SYP pressure treated lumber and attached to the cement bulkhead. It will be handicap accessible and have a lockable gate.

Aluminum gangway - will be 30' long and 3.5' wide It will attach to the headworks with hooks and D rings. The lower end of the gangway will have rollers and land on top of the first float section of the dock system.

Floats - ten 24'X10' float sections constructed from #2 severe service SYP pressure treated lumber with galvanized corner brackets, through bolted to internal galvanized gussets. Frame will be 4"x8" with 2"x10" skirt boards and 2"x6" decking. A raised 2"x4" rail suitable for attaching vessel dock lines will be on the 24' sides of each float and the 10' ends of the three end floats. Floatation will be drums providing a minimum of 5,000 pounds of reserve buoyancy pre float and approximately 18" of unloaded freeboard.

Three floats will be used perpendicular to the riverbank to gain adequate distance out into the river. The remaining seven float sections will run parallel to the riverbank providing 170' of parallel berths.

Connectors and Hardware- All connections, mooring attachments, fasteners and hardware will be galvanized steel or stainless steel.

Moorings - Helical moorings of adequate number and size will be placed into the riverbed. Chain rodes will attach the moorings to the dock system. Additionally, there will be chain rodes pinned to shore riprap holding the 3 perpendicular dock sections in place. Chain will be 5/8" galvanized, long link, domestic, mooring chain. Shackles will be domestic galvanized as well. Contractor will provide follow up visit(s) to adjust mooring chains for even load distribution after the dock system is installed.

Permitting – the dock system will be permitted by contractor as a temporary/removable structure. The floats and gangway will be removed from the water and stored by the Bath Captains Association from December through March each year.

Additional information for this Design-Bid RFP:

Vessels berthed on the dock system – There will be a total of nine fiberglass outboard powered boats ranging in length from 20'-25'.

23' Parker cuddy cabin 4,800 pounds.

22' Biddison cuddy cabin 4,000 pounds.

22' Parker center console with T top 3,200 pounds.

20' Hewes center console 1,600 pounds.

20' Jones Brother center console 3,000 pounds.

22' Key West Center Console with T top 4,500 pounds.

25' G3 tri hull pontoon boat 3,000 pounds.

25' Latitude center console with half tower 4,900 pounds.

21' Pair Custom center console 3,800 pounds.

River Dynamics:

Current- peak current velocities happen on ebb tides. The flood tide runs at lesser velocity due to the natural outflow of the river counteracting the ocean's incoming tidal push. On one astronomically high tide, peak current velocity at the dock location was 3.6kts.

Current on both flood and ebb runs parallel to the river's west shoreline.

There is a NOAA current station 1,000 yards south of the dock location. It is located mid-river near the Bath Iron Works rigging pier. Attached is a comparison of the NOAA current station table with actual current speed observations at the dock location recorded on 12/23/22.

Tides – maximum tide range 9.5'. Minimum tide range 5.5'

Waves - There is a considerable fetch at the dock location when the tide is ebbing and there is a strong southerly wind. 2'-2.5' waves can occur. Similar wave action can occur on the flood tide with a strong northerly wind.

Westerly and easterly winds do not produce waves or chop over 12".

Wind - Easterly winds will produce a considerable perpendicular wind load on the dock and boats. The dock is sheltered from westerly wind due to the proximity to the river's west bank.

East, north and south wind exposure will be very similar to the NOAA weather predictions for Bath. The Rt. 1 bridge and the Bath Iron works facility will have a slight blocking effect on southerly winds.

Riverbed – The water depth at the dock's helix mooring locations ranges from 30'-45' at mean low tide. Bottom is fine to medium gravel. Depth to bedrock is unknown. There were wood piles driven to adequate depth 100 yards north of the dock location.

Bath Water District water main – The sketch shows the location of the water main. The pipe is subterranean at the shoreline. It emerges from the riverbed at about 30' water depth and is elevated above the riverbed on pilings from that point on across the river to the Woolwich shore where the Reed and Reed barge rigging facility is.

To conduct a site visit contact Capt. Dave Pecci 207-841-1444 Obsessioncharters@gmail.com

Date Time (LST/LDT)	Speed d kts	highest Observed Speed kts during each 6 min segment	paddlewheel sensor 18" below surface NE wind 6 kts or less during entire period
NOAA station CAB142 Bath Iron Works		Charter boat dock location	
43.9038*N		43.9118*N	
69.8093*W		69.8120*W	
Depth 4'		1.5' depth	percent variance

12/22/2022 14:00	2.81	3.40	1.21%
12/22/2022 14:06	2.87	3.20	1.11%
12/22/2022 14:12	2.91	2.90	0%
12/22/2022 14:18	2.94	3.10	1.05%
12/22/2022 14:24	2.96	2.90	1.01%
12/22/2022 14:30	2.97	3.00	0%
12/22/2022 14:36	2.97	2.90	0.98%
12/22/2022 14:42	2.96	3.40	1.15%
12/22/2022 14:48	2.94	3.20	1.09%
12/22/2022 14:54	2.92	3.60	1.23%
12/22/2022 15:00	2.89	3.10	1.07%
			Average variance 1.10% Max variance 1.23%

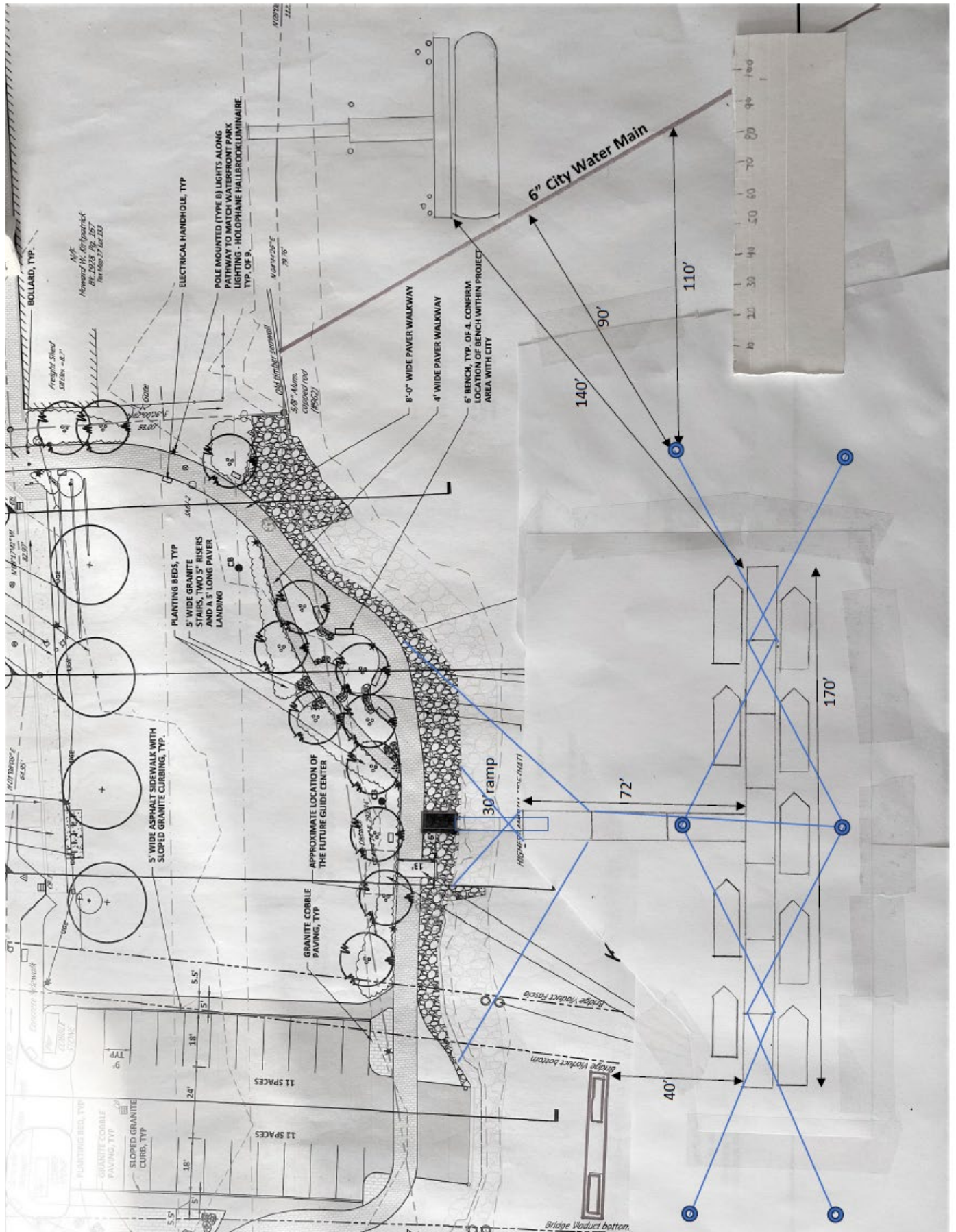

THIS DOCUMENT MUST BE CLEARLY POSTED AT ALL CONSTRUCTION SITES FUNDED IN PART WITH STATE FUNDS

State of Maine Department of Labor - Bureau of Labor Standards
Augusta, Maine 04333-0045 - Telephone (207) 623-7906

Wage Determination - In accordance with 26 MRS §1301 et. seq., this is a determination by the Bureau of Labor Standards, of the fair minimum wage rate to be paid to laborers and workers employed on the below titled project.

2024 Fair Minimum Wage Rates -- Heavy & Bridge Sagadahoc County

Occupational Title	Minimum Wage	Minimum Benefits	Total
Brickmasons And Blockmasons	\$35.00	\$0.86	\$35.86
Bulldozer Operator	\$31.50	\$7.53	\$39.03
Carpenter	\$30.65	\$3.99	\$34.64
Cement Masons And Concrete Finisher	\$24.35	\$15.65	\$40.00
Commercial Divers	\$28.00	\$1.85	\$29.85
Construction And Maintenance Painters	\$24.50	\$5.24	\$29.74
Construction Laborer	\$24.46	\$3.17	\$27.63
Crane And Tower Operators	\$32.90	\$7.53	\$40.43
Crushing Grinding And Polishing Machine Operators	\$23.00	\$4.94	\$27.94
Drywall And Ceiling Tile Installers	\$26.20	\$10.62	\$36.82
Earth Drillers - Except Oil And Gas	\$24.16	\$2.53	\$26.69
Electrical Power - Line Installer And Repairers	\$36.00	\$6.09	\$42.09
Electricians	\$34.54	\$10.71	\$45.25
Elevator Installers And Repairers	\$68.38	\$45.29	\$113.67
Excavating And Loading Machine And Dragline Operators	\$30.00	\$5.10	\$35.10
Excavator Operator	\$33.25	\$5.20	\$38.45
Fence Erectors	\$24.00	\$2.05	\$26.05
Flaggers	\$20.00	\$0.50	\$20.50
Floor Layers - Except Carpet/Wood/Hard Tiles	\$27.00	\$6.21	\$33.21
Glaziers	\$37.00	\$6.60	\$43.60
Grader/Scraper Operator	\$23.00	\$1.99	\$24.99
Hazardous Materials Removal Workers	\$21.50	\$1.54	\$23.04
Heating And Air Conditioning And Refrigeration Mechanics And Installers	\$32.00	\$5.46	\$37.46
Heavy And Tractor - Trailer Truck Drivers	\$27.96	\$4.08	\$32.04
Highway Maintenance Workers	\$20.00	\$0.00	\$20.00
Industrial Machinery Mechanics	\$32.00	\$0.96	\$32.96
Industrial Truck And Tractor Operators	\$30.00	\$2.90	\$32.90
Insulation Worker - Mechanical	\$24.05	\$3.59	\$27.64
Ironworker - Ornamental	\$27.75	\$4.50	\$32.25
Light Truck Or Delivery Services Drivers	\$22.84	\$1.25	\$24.09
Millwrights	\$32.00	\$8.07	\$40.07
Mobile Heavy Equipment Mechanics - Except Engines	\$29.50	\$4.32	\$33.82
Operating Engineers And Other Equipment Operators	\$28.00	\$2.67	\$30.67
Paver Operator	\$25.30	\$3.73	\$29.03
Pile-Driver Operators	\$32.75	\$1.95	\$34.70
Pipelayers	\$28.50	\$4.89	\$33.39
Plumbers Pipe Fitters And Steamfitters	\$33.00	\$20.11	\$53.11
Pump Operators - Except Wellhead Pumps	\$31.49	\$32.08	\$63.57
Radio Cellular And Tower Equipment Installers	\$27.00	\$4.01	\$31.01
Reclaimer Operator	\$27.03	\$7.68	\$34.71
Reinforcing Iron And Rebar Workers	\$30.83	\$24.97	\$55.80
Riggers	\$31.25	\$7.68	\$38.93
Roofers	\$24.00	\$3.35	\$27.35
Screed/Wheelman	\$29.25	\$4.94	\$34.19
Sheet Metal Workers	\$27.38	\$6.74	\$34.12
Structural Iron And Steel Workers	\$30.00	\$5.74	\$35.74
Tapers	\$28.00	\$1.71	\$29.71
Telecommunications Equipment Installers And Repairers - Except Line Installers	\$28.33	\$6.08	\$34.41
Telecommunications Line Installers And Repairers	\$26.00	\$4.30	\$30.30
Tile And Marble Setters	\$27.75	\$6.73	\$34.48

Welders are classified as the trade to which welding is incidental (e.g. welding structural steel is Structural Iron and Steel Worker)

Apprentices – The minimum wage rates for registered apprentices are the rates recognized in the sponsorship agreement for registered apprentices working in the pertinent classification.

For any other specific trade on this project not listed above, contact the Bureau of Labor Standards for further clarification.

Title 26 §1310 requires that a clearly legible statement of all fair minimum wage and benefits rates to be paid the several classes of laborers, workers and mechanics employed on the construction on the public work must be kept posted in a prominent and easily accessible place at the site by each contractor and subcontractor subject to sections 1304 to 1313.

Appeal – Any person affected by the determination of these rates may appeal to the Commissioner of Labor by filing a written notice with the Commissioner stating the specific grounds of the objection within ten (10) days from the filing of these rates.

A true copy

Attest: 

Scott R. Cotnoir
Wage & Hour Director
Bureau of Labor Standards

Expiration Date: 12-31-2024
Revision Date: 1-3-2024

Cost Proposal Form

I/we, the undersigned, hereby propose to provide the Charter Boat Dock as described in the RFP and are hereby submitting the following Cost Proposal for consideration:

Total Cost (Not-to-Exceed): \$ _____

Amount in Written Figures: _____

SIGNATURE: _____ **Date:** _____

Print Name: _____

Firm Name: _____

Address: _____

Phone: _____

Email: _____